



ampeg

*Heritage*

## 50th Anniversary SVT Quick Start Guide



# What's in the Box

Heritage™ 50th Anniversary SVT® Amplifier, Power Cable, Quick Start Guide.

## Hookup Diagrams

### Standard Setup

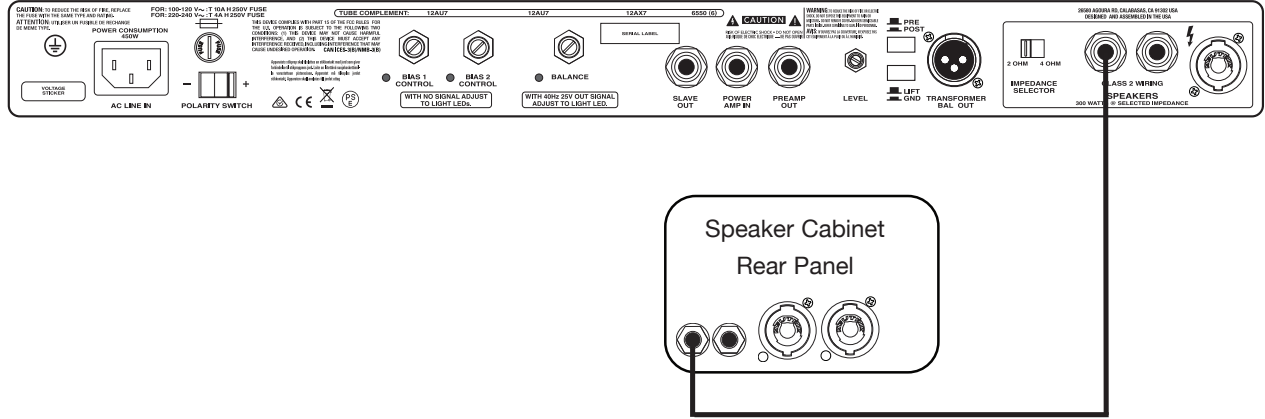

### Parallel Setup

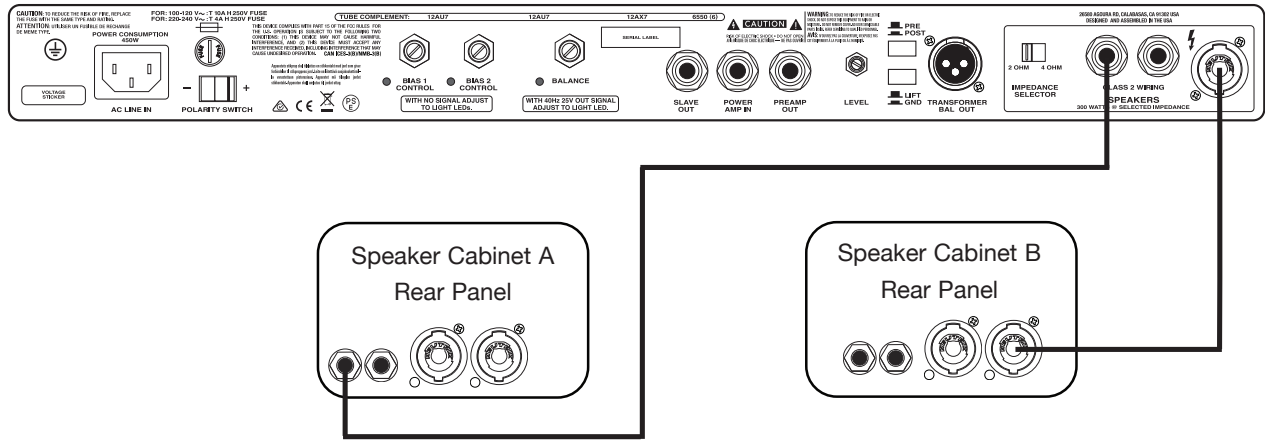

### Daisy Chaining

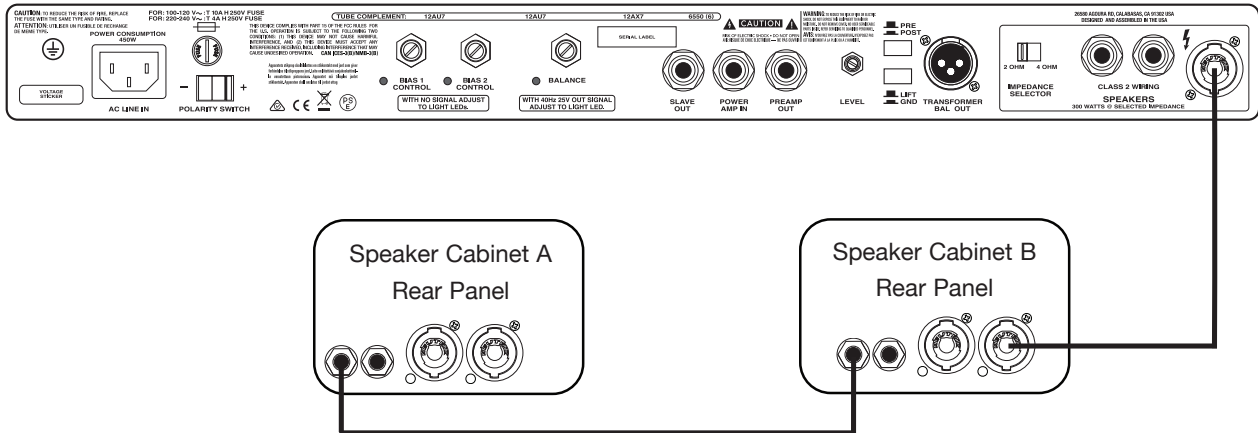

Note: Use same impedance cabinets in parallel setups and when daisy-chaining

# Channel Jumping

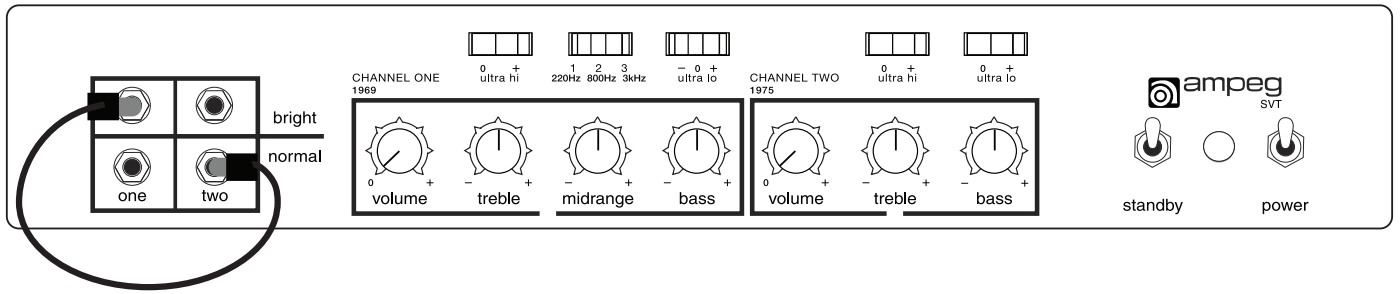

Note: Start with both channel Volume knobs at 0 to avoid loud bursts of audio.

# Front & Rear Panels

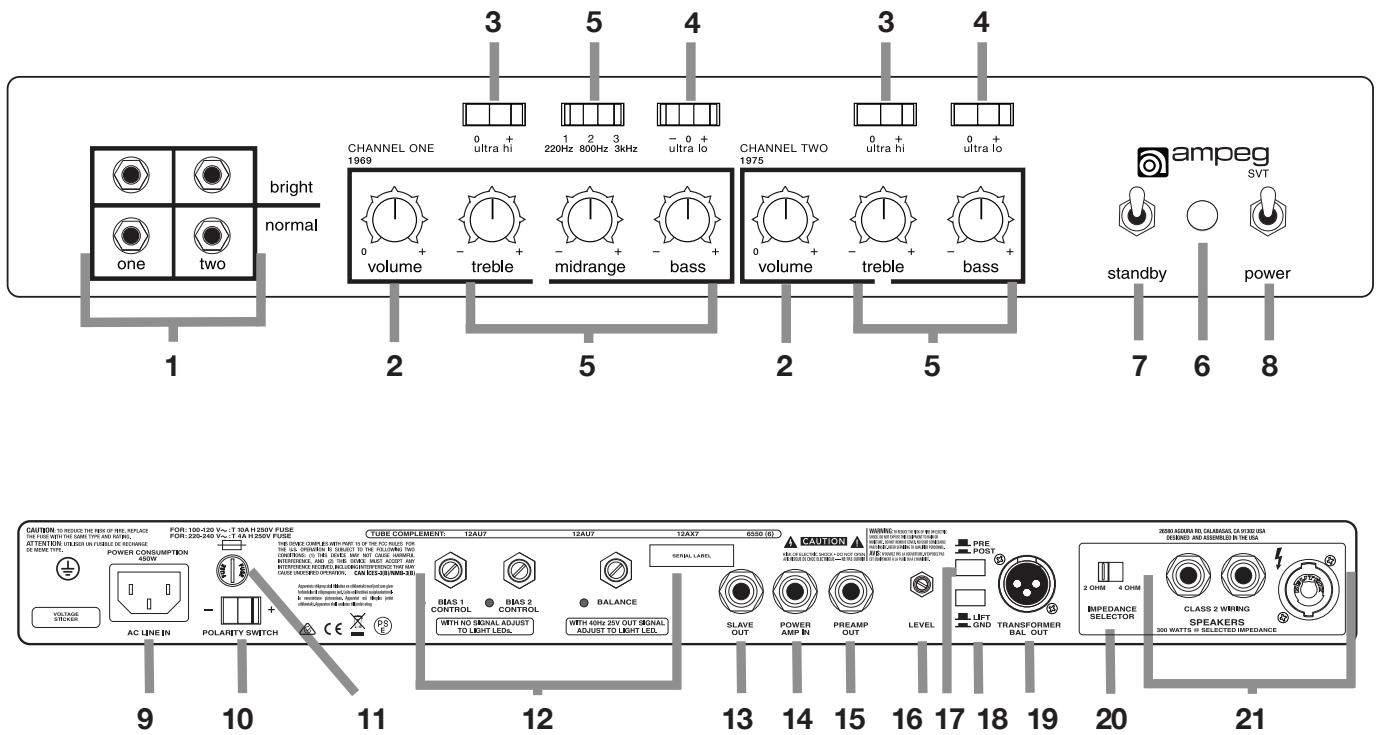

## Front & Rear Panel Descriptions

1. **Inputs One/Two (Bright/Normal):** Connect an instrument to one of these four 1/4" Input jacks.
2. **Volume:** Controls the overall output level per channel.
3. **Ultra Hi:** Boosts the high frequencies.
4. **Ultra Lo:** Boosts the low frequencies.
5. **EQ:** Boost or cut the level at certain frequencies to enhance the sound.
6. **Standby/Power LED:** Multi-function LED illuminates red in Standby mode and green when powered on.
7. **Standby Switch:** Turns Standby on and off.
8. **Power Switch:** Turns the Power on and off.
9. **Power Connector:** Input socket for power cable.
10. **Polarity Switch:** Removes electrical buzz.
11. **Fuse:** Overload and AC line surge protection.
12. **Bias/Balance:** Controls and LEDs for user biasing.
13. **Slave Out:** Feed another amp (slave) from this unit's preamp.
14. **Power Amp In:** Bypasses the internal preamp.
15. **Preamp Out:** Feeds an external amplifier or powered speaker.
16. **Level:** Adjusts the signal level at the Balanced Output jack.
17. **Pre/Post Switch:** Set the Balanced Output jack to Pre-EQ (disengaged) or Post-EQ (engaged).
18. **Lift/Gnd:** Connects the ground connection at the Balanced Output jack.
19. **Balanced Out:** Feeds the signal from the Power Amp Input to an external power amplifier, mixer, or recording setup.
20. **Impedance Selector:** Match the output impedance of the amp to the speaker(s).
21. **Speaker Outputs:** 1/4" TS / speakON® outputs for connecting speakers.

## Getting Started

1. Read and understand the included *Important Safety Instructions*.
2. Make sure the Power and Standby switches are both in the "down" position before making any connections.
3. Push the line cord securely into the amplifier's IEC connector and plug the other end into a grounded AC outlet. The amplifier may accept the appropriate voltage as indicated near the IEC connector.
4. Connect an instrument to the amplifier's Input jack with a (shielded) 1/4" instrument cable. Connect speaker cables to speaker cabinets with (non-shielded) speaker cable with speakON or 1/4" TS ends.
5. With the Volume knobs fully off, turn the Power switch on. The Power LED will illuminate. Wait 30 seconds.
6. Turn the Standby switch to the "up" position, to toggle Standby mode off.
7. While playing the instrument, adjust the Volume knobs to the preferred level.
8. Adjust the EQ knobs and switches to taste.

## Technical Specifications

	Heritage 50th Anniversary SVT
Preamp Tubes	Premium 12AX7 (x5)
Driver Tubes	Premium 12AX7 (x1), 12AU7 (x2)
Power Amp Tubes	Ampeg Super Valve™ 6550 (x6)
Output Power Rating	300W RMS minimum continuous @ <5% THD @ 2 Ω or 4 Ω
Signal-to-Noise Ratio (20 Hz – 20 kHz)	75 dB (20 Hz–20 kHz)
Maximum Gain	78 dB @ 1 kHz -3 dB @ 20 Hz & 15 kHz
Tone Controls	Bass: +12/-12 dB @ 40 Hz Midrange: +20/-20 dB @ 220 Hz, 800 Hz, or 3 kHz Treble: +12/-12 dB @ 4 kHz Ultra Hi: +15 dB @ 8 kHz (Volume @ 50%) Ultra Lo: -20 dB @ 600 Hz Bass Cut: -20 dB @ 40 Hz
Power Requirements	120V AC, 50–60 Hz, 400W 100V AC, 50–60 Hz, 400W 220–240V AC, 50–60 Hz, 400W
Size (H x W x D)	11.5 x 24.0 x 12.75 in 292 x 610 x 324 mm
Weight	85 lb 38.6 kg

All specifications subject to change.



## WARRANTY AND SUPPORT

Visit [WWW.AMPEG.COM](http://WWW.AMPEG.COM) to...

- (1) ...identify **WARRANTY** coverage provided in your local market. Please keep your sales receipt in a safe place.
- (2) ...retrieve a full-version, printable **OWNER'S MANUAL** (English only) for your product.
- (3) ...**REGISTER** your product.
- (4) ...**CONTACT** Technical Support, or call 818-575-3600.

www.ameg.com  
Yamaha Guitar Group, Inc.  
26580 Agoura Road, Calabasas, CA 91302-1921 USA  
Part No. 40-00-0428 Rev B



© 2019 Yamaha Guitar Group, Inc. All rights reserved.

Ampeg, the Ampeg logo, Heritage, Ampeg Super Valve, and SVT are trademarks or registered trademarks of Yamaha Guitar Group, Inc. in the U.S. and/or other jurisdictions. speakON is a registered trademark of Neutrik AG Corporation.